



# Portable Extractor Products

1XP Series Pumps



Product Quality, Reliability and Support You Expect

[www.catpumps.com](http://www.catpumps.com)



# Decrease Downtime and Increase Profits with Cat Pumps

## Quality that keeps your equipment running

One of the most critical components in a portable extractor is the pump. Because the pump sees system pressures and works with a variety of fluids, it has a tough job to do. Specifying the best pump for the application is vital to long trouble-free service. That's where Cat Pumps comes into play.

Our commitment to produce the highest-quality, longest lasting products available is supported by maintaining a rigorous zero defect quality assurance program to guarantee consistently high-quality products — every time.

### Cat Pumps Benefits:

- Jobs done on schedule with less downtime
- Fewer repairs for reduced maintenance costs
- Fast turnaround for parts & pumps – 24 hour shipping

## Engineering and Technical Support

Cat Pumps offers engineering and technical support for product selection, installation, maintenance, pump repair, troubleshooting and custom designed systems. Live Support available M-F, 8:00 a.m. to 5:00 p.m CST, 763-780-5440 and at [techsupport@catpumps.com](mailto:techsupport@catpumps.com). Product service videos located at [www.catpumps.com](http://www.catpumps.com)

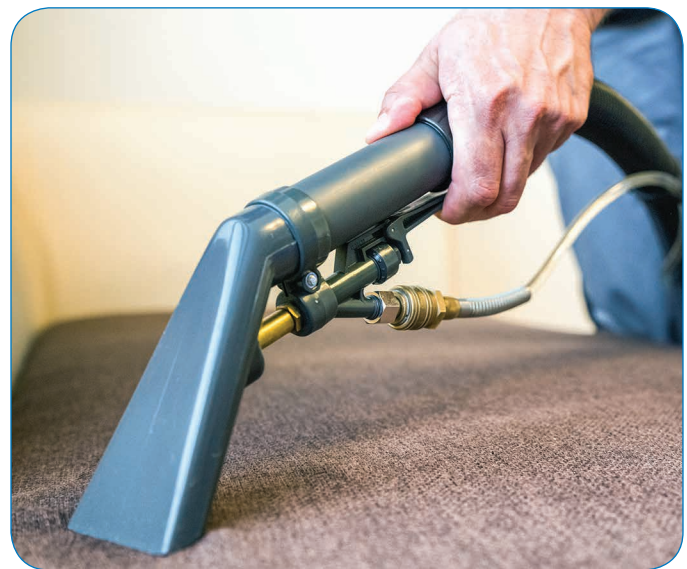

## Readily Available – Off the Shelf

In addition to receiving the highest quality products available, Cat Pumps customers also benefit with the following:

- Pumps and repair parts are stock items
- Quick response with 95% of orders ship within 24 hours
- Worldwide sales and service channel stocking genuine Cat Pumps products

# 1XP Features add up to long life and trouble-free service

## 1 Easily Primed

- Self-Priming – just turn it on
- Cat Pumps exclusive Super Flow Technology

## 2 Patented Greaseless Design

- Greaseless = no maintenance
- Greaseless = no grease stains
- 100% sealed wet end = no leakage

## 3 Solid Ceramic Plungers

- Improved seal life – ceramic does not score like stainless steel plungers
- Ceramic plungers do not require changing when replacing seals

## 4 Conveniently Located Ports

- Easy to assemble and maintain
- Improved Inlet conditions

## 5 Proven High-Pressure Seals

- Consistent quality
- Life measured in thousands of hours

## 6 Supported Crankshaft

- Crankcase supports motor shaft with water lubricated bearing
- Reduces side load and extends seal life

## 7 Industrial Motors

- AC (Induction)
- DC (Permanent Magnet)

## 8 Easy to Drain

- Faster service
- Less mess

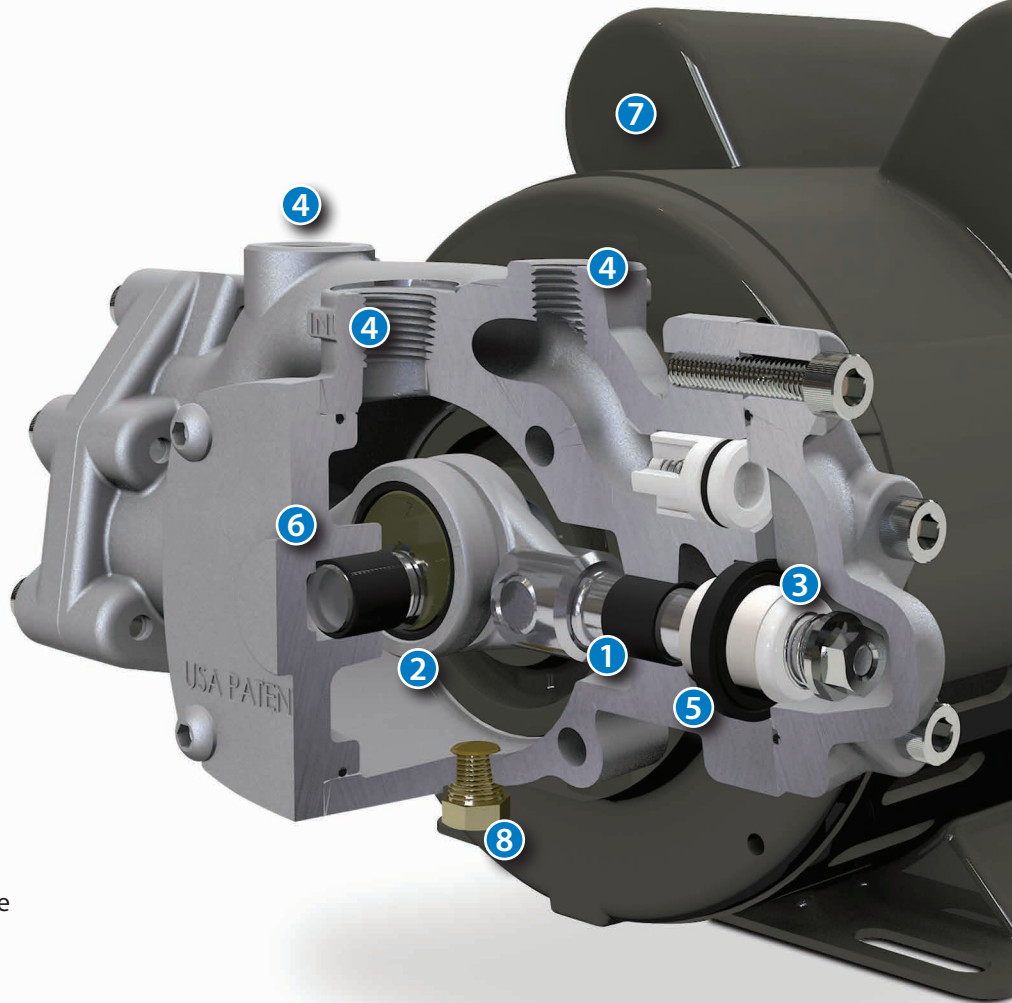

## Compact Design

The 1XP Series Pumps are designed for high performance with a small footprint.

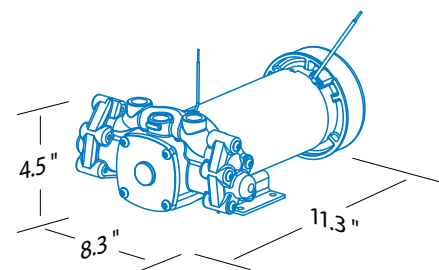
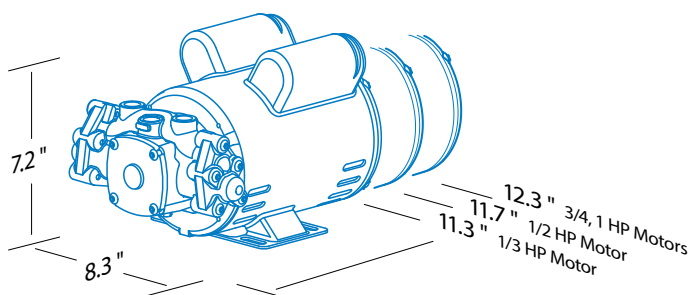

# 1XP — Raising the Bar on Quality

Cat Pumps set out to design the best extractor pump available

## Customers asked for three things:

1. Build a pump that lasts longer than the competition
2. Make the pump easy to retrofit into existing equipment
3. Develop a design that will not leak and put contamination on the surface being cleaned

No detail was overlooked to make the 1XP the best choice for portable extractor applications. A patented greaseless design and 100% sealed wet-end means no maintenance and zero leaks. Solid ceramic plungers do not score and wear like stainless steel plungers — so pump life is increased by a factor of 10 or more in some cases.

Customers who have upgraded their extractors to the 1XP have reported smoother and quieter operation, faster and more consistent priming, and greatly increased pump life. It's time to say goodbye to that old carpet cleaning pump and upgrade to the 1XP.

### Pump

Flow :	0.5 – 2 gpm
Pressure range:	100 – 1000 psi
RPM:	1750 (60 Hz) 1450 (50 Hz)
Inlet Pressure Range:	Gravity to 40 psi
Maximum liquid temperature:	140° F
Inlet Port:	3/8" NPT(F)
Discharge Ports:	3/8" NPT(F)
Seals:	Fluorocarbon (FPM)
Manifold:	Plated Aluminum

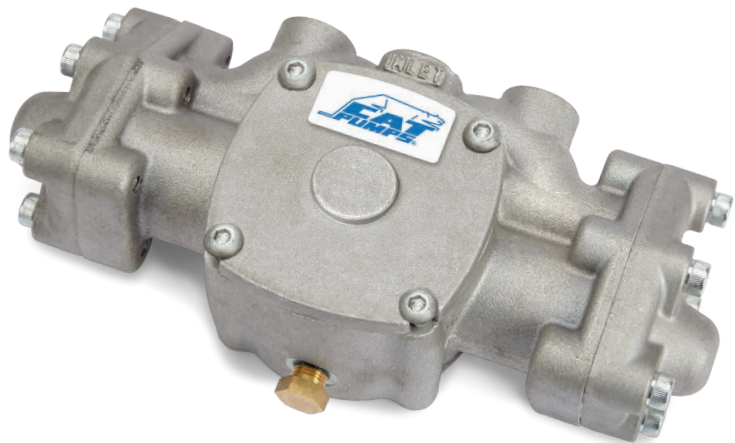

### AC (Induction) Motor

HP	1/3, 1/2, 3/4, 1
Type	ODP
Volts	115/230
Hz	50/60
RPM	1450/1750
Phase	Single
Service Factor	1.0/1.35 (50/60)
Start	Capacitor
Recognized	CE, UL, and CSA

### DC (Permanent Magnet) Motor

HP	1/3
Type	ODP, TEFC
Volts	120, 240 Rectified DC
RPM (at rated load)	1750
Service Factor	1

### Patented water-lubricated technology

- Designed to fit extractor space and footprint
- Supported by Cat Pumps industry-leading customer service
- Off-the-shelf delivery
- Highest quality control means long life and hours of trouble-free service



AC (Induction) Motor



DC (Permanent Magnet) Motor

# Selection Charts

Wide range of options for world-wide acceptance

## 1XP Pump with AC Induction Motor

- Long Service Life
- Dual Frequency for world-wide use
- Constant torque



### AC Induction Motor – 60 Hz, 120V (1750 rpm)

GPM	Max PSI	Pump Assembly	SFA	HP
0.5	600	1XP050.031		
0.75	500	1XP075.031		
0.85	500	1XP085.031		
1	450	1XP100.031	4.0	1/3
1.25	400	1XP125.031		
1.5	325	1XP150.031		
2	250	1XP200.031		
0.4	1000	1XP050.051		
0.7	1000	1XP075.051		
0.8	1000	1XP085.051		
0.9	800	1XP100.051	8.0	1/2
1.2	800	1XP125.051		
1.5	600	1XP150.051		
2	450	1XP200.051		
0.9	1000	1XP100.071		
1.1	1000	1XP125.071		
1.4	800	1XP150.071	9.0	3/4
1.75	700	1XP180.071		
2	550	1XP200.071		
1.45	1000	1XP150.101		
1.8	800	1XP180.101	12.6	1
2	750	1XP200.101		

### AC Induction Motor – 50 Hz, 240V (1450 rpm)

GPM	Max PSI	Pump Assembly	SFA	HP
0.40	600	1XP050.031		
0.60	500	1XP075.031		
0.70	500	1XP085.031		
0.80	450	1XP100.031	2.1	1/3
1	400	1XP125.031		
1.2	325	1XP150.031		
1.70	250	1XP200.031		
0.30	1000	1XP050.051		
0.60	1000	1XP075.051		
0.70	1000	1XP085.051		
0.75	800	1XP100.051	3.8	1/2
1	800	1XP125.051		
1.2	600	1XP150.051		
1.70	450	1XP200.051		
0.75	1000	1XP100.071		
0.90	1000	1XP125.071		
1.20	800	1XP150.071	4.6	3/4
1.50	700	1XP180.071		
1.70	550	1XP200.071		
1.20	1000	1XP150.101		
1.40	800	1XP180.101	6.3	1
1.70	750	1XP200.101		

## 1XP Pump with DC Permanent Magnet Motor

- Low amp draw
- Compact
- Lighter weight



### DC Permanent Magnet – 120 Volt - 1/3 HP ODP and TEFC Enclosures

GPM	Max PSI	Amps (at max psi)	Pump Assembly ODP Motor	Pump Assembly TEFC Motor
0.5	600	4.0	1XP050.03DC	1XP050.03DCT
0.75	500	4.0	1XP075.03DC	1XP075.03DCT
0.85	400	4.0	1XP085.03DC	1XP085.03DCT
1	350	4.0	1XP100.03DC	1XP100.03DCT
1.25	300	4.0	1XP125.03DC	1XP125.03DCT
1.5	250	4.0	1XP150.03DC	1XP150.03DCT
2.3	150	4.0	1XP200.03DC	1XP200.03DCT

### DC Permanent Magnet – 240 Volt - 1/3 HP ODP

GPM	Max PSI	Amps (at max psi)	Pump Assembly ODP Motor
0.5	600	2.0	1XP050.03DC2
0.75	500	2.0	1XP075.03DC2
0.85	400	2.0	1XP085.03DC2
1	350	2.0	1XP100.03DC2
1.25	300	2.0	1XP125.03DC2
1.5	250	2.0	1XP150.03DC2
2.3	150	2.0	1XP200.03DC2

# Accessories

Cat Pumps offers a wide range of high quality accessories adhering to the same exacting standards as our industry-leading pumps. Every accessory is performance tested and designed to match each pump's operating specifications. By demanding genuine Cat Pumps products, you receive the best value and lowest cost of ownership over the life of the system. Protect your pumping system investment with the brand you can trust — Cat Pumps.



## Pressure Relief Valve

Used when constant pressure is required.

- Heavy Duty; mounts conveniently into discharge line
- Wide pressure and flow range model available

Model	Max GPM	PSI Range	Ports
7084C	3.5	100 - 600	1/4"
7085C	3.5	200 - 2300	1/4"
7561	4	100 - 1000	1/4"
7189	6.6	100 - 650	3/8"
7582.100	8	100 - 1000	3/8"
7583.100	8	250 - 2000	3/8"



## Pressure Regulating Unloaders

Typically used with trigger gun applications.

- Reduces load on pump and motor when in bypass.
- Wide pressure and flow range models available.

Model	Max GPM	PSI Range	Ports
7582	8	100 - 1000	3/8"
7583	8	250 - 2000	3/8"

## Pressure Gauges

Accurately monitors pump outlet pressure.

- Glycerine filled for consistent and accurate pressure readings.
- Sealed stainless steel case eliminates corrosion risk.



Model	Max Pressure (PSI)	Port
6091	1000	1/4" NPT(M), Bottom
6092	1000	1/4" NPT(M) Rear
6086	1500	1/4" NPT(M), Bottom

## Inlet Strainers

Used to filter out solid particles

- Durable nylon body for corrosion resistance
- Easily cleaned without removing from plumbing

Model	Max GPM	Port
7203.3	10	1/2" NPT(M)
7204.4	10	1/2" NPT(F)



## Vari-Nozzle

Adjustable high or low pressure and 0 - 60 degree spray pattern.

- Molded insulated grip for easy operation
- Color coded plug for easy nozzle size identification

Model	Nozzle #
7920	2
7930	3
7935	3.5
7940	4



7920

## Shut-Off Guns

Smooth trigger action reducing operator fatigue.

- Stainless steel ball and seat for extended life
- Safety lock prevents unintentional operation

Model	Max GPM	Max PSI	Inlet Port Location	Inlet Port	Discharge Port
33425	8	2900	Front	3/8" NPT(F)	1/4" NPT (F)
76165	8	4000	Bottom	3/8" NPT (F)	1/4" NPT (F)
31137	10.5	4500	Rear	3/8" NPT (F)	1/4" NPT (F)



33425

76165

31137

## Service Kits

Service and Maintenance parts in stock available for immediate shipment.

Part Number	Description
76227	Inlet Valve Kit
76218	Discharge Valve Kit
76219	Seal and O-Ring Kit
76555	Plunger Rod Assembly



## ABOUT CAT PUMPS

## Proven Quality, Customer Focused

Cat Pumps is the world leader in the design, manufacture and marketing of the most dependable high-pressure positive displacement reciprocating triplex pumps and systems in the market. Our mission to exceed customer expectations for quality, reliability, availability, delivery, technical expertise and aftermarket support to assure the best value in all the industries served.

## LOCATIONS

### Worldwide Headquarters

#### Cat Pumps

1681 94th Lane Northeast  
Minneapolis, MN 55449  
USA

P: 763-780-5440  
F: 763-780-2958  
techsupport@catpumps.com  
www.catpumps.com

**Territories Served**  
U.S., Canada

#### International Division

P: 763-780-5440  
F: 763-785-4329  
intlsales@catpumps.com  
www.catpumps.com

**Territories Served**  
Africa, Asia, Australia, Central and  
South America, Mexico, Middle East,  
New Zealand, Turkey

#### Cat Pumps International N.V.

Heiveldekens 6A  
2550 Kontich  
Belgium

P: 32 3 450 71 50  
F: 32 3 450 71 51  
cpi@catpumps.be  
www.catpumps.be

**Territories Served**  
Western Europe (except U.K.,  
Germany, and Austria)

#### Cat Pump (U.K.) Ltd.

1 Fleet Business Park, Sandy Lane  
Church Crookham  
FLEET, Hampshire GU52 8BF  
England

P: +44 1252 622031  
F: +44 1252 626655  
sales@catpumps.co.uk  
technical@catpumps.co.uk  
www.catpumps.co.uk

**Territories Served**  
U.K. and Ireland

#### Cat Pumps Deutschland GmbH

Buchwiese 2, D-65510  
Idstein  
Germany

P: +49 6126 9303 0  
F: +49 6126 9303 33  
catpumps@t-online.de  
www.catpumps.de

**Territories Served**  
Austria, Commonwealth of Independent States  
(CIS), Germany and Eastern Europe

## SALES, DISTRIBUTION, SERVICE

Call today for product and application assistance.  
763-780-5440 or visit us at [www.catpumps.com](http://www.catpumps.com)



#### CAT PUMPS

1681 - 94TH LANE N.E. MINNEAPOLIS, MN 55449-4324  
PHONE (763) 780-5440 — FAX (763) 780-2958  
e-mail: [info@catpumps.com](mailto:info@catpumps.com)  
[www.catpumps.com](http://www.catpumps.com)

For International inquiries go to [www.catpumps.com](http://www.catpumps.com) and navigate to the "Contact Us" link.